

# HW8 PUMP

## PERFORMANCE

|                          |                             |
|--------------------------|-----------------------------|
| <b>Maximum Outflow</b>   | 3,970 US gpm (15,028 L/min) |
| <b>Maximum Head</b>      | 660 feet (201 m)            |
| <b>Solids Handling</b>   | 2" (51 mm) diameter         |
| <b>BEP with 15' lift</b> | 2,750 US gpm @ 620 feet     |



## PUMP FEATURES

- High Head Water (HW) pumps are designed for high head jobs with very few solids
- Variety of pump applications including sewage, liquids, sludge and liquids with solids up to 2" (51 mm) in diameter
- Standard engine CAT C18-630 hp
- Stressproof™ stainless steel shaft with innovative Cycloseal® (Tungsten Carbide vs. Silicon Carbide) that increases the seal life by up to three times that of a typical mechanical seal
- Oil bath feeds the mechanical seal with cooler oil for continuous dry running
- Steel construction skid. Also available with an industrial grade, off-road trailer mount
- Automatic Priming System sucks air and liquid at the same time. Primes and re-primers completely unattended
- Priming system built with in-line ¼ turn isolation valve for flooded suction applications
- Auto-Start/Stop Water Level Control
- At its Best Efficiency Point this pump is 74% efficient, which reduces energy costs compared to other pumps
- Heavy duty, massive pump shafts, purposely built for industrial applications
- Optional remote monitoring with live updates that include: pump's global position, discharge pressure, engine data and maintenance log
- Optional, easily removable protective Quiet Container that reduces sound down to 70 dB at 28ft away
- Warranted by Mighty Pumps, Cornell and CAT- 2 year, 2,000 hour warranty

## PERFORMANCE CURVE

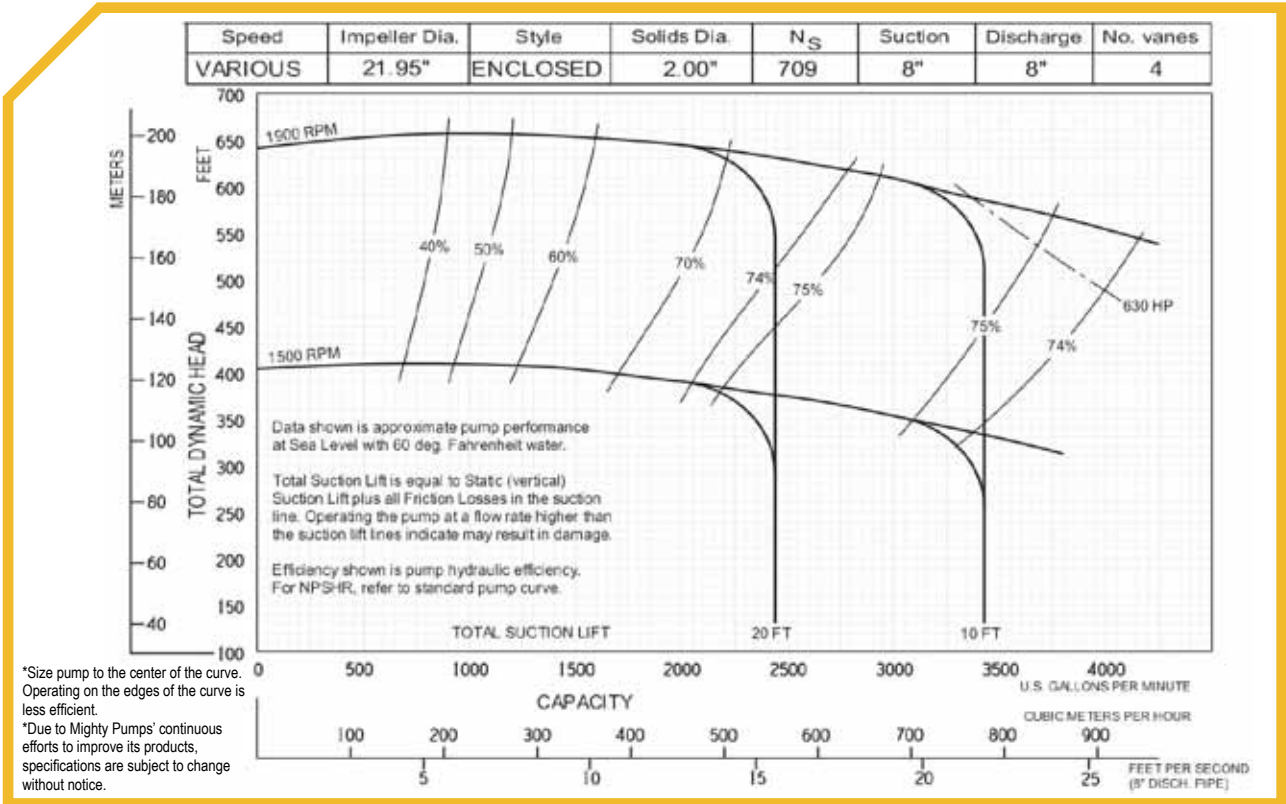

# HW8 PUMP

## SPECIFICATIONS

|                              |                           |
|------------------------------|---------------------------|
| Engine                       | CAT C18-630 hp continuous |
| Pump End                     | Cornell 6822MX            |
| Mounting                     | Skid                      |
| Fuel Tank Capacity           | 400 US gallons (1,514 L)  |
| Fuel Consumption (1,800 rpm) | 30.9 US gal/hr            |
| Run Time* (1,800 rpm)        | 13 hours                  |
| Maximum Operating Speed      | 1,900 rpm                 |
| Max Case Pressure            | 350 psi (2,413 kPa)       |
| Max Fluid Temperature        | 180°F (82°C)              |
| Suction Inlet Size           | 8" 150 lb Flange          |
| Discharge Outlet Size        | 8" 300 lb Flange          |

\*one tank of fuel

## DIMENSIONS

|              |                      |
|--------------|----------------------|
| Height       | 91" (2,311 mm)       |
| Width        | 68" (1,727 mm)       |
| Length       | 158" (4,013 mm)      |
| Weight (Wet) | 16,352 lb (7,417 kg) |

## PUMP MATERIALS

|                |  |
|----------------|--|
| Volute         | ASTM A536-72 Ductile Iron                                  |
| Wear Rings     | ASTM A48 Cast Iron   |
| Backplate      | ASTM A536-72 Ductile Iron                                  |
| Impeller       | CA6 Cast Steel   |
| Frame          | ASTM A48 Cast Iron   |
| Shaft          | Stress Proof SAE 1144 Steel                                |
| Shaft Seal     | Tungsten Carbide vs. Silicon Carbide or Carbon vs. Ceramic |
| Engine Bracket | ASTM A48 Cast Iron   |
| Skid           | CSA G40.21 44W Steel                                       |

## CORNELL 6822MX

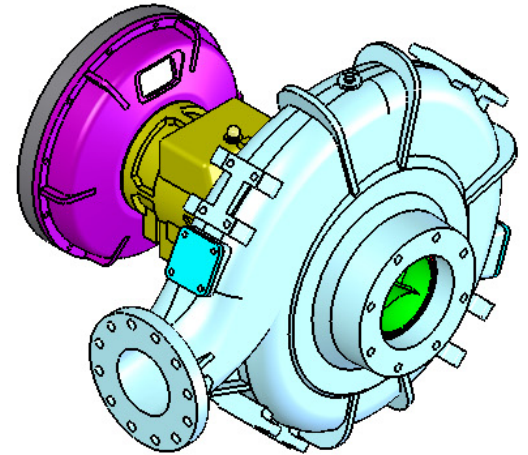

## MIGHTY PUMPS FAMILY CURVE

